

DATA SHEET GS34

GALAXY STAGE®

HIGH QUALITY TRUSS, CLAMPS & ACCESSORIES

GS34 11.4" X 11.4" ALUMINUM BOX TRUSS

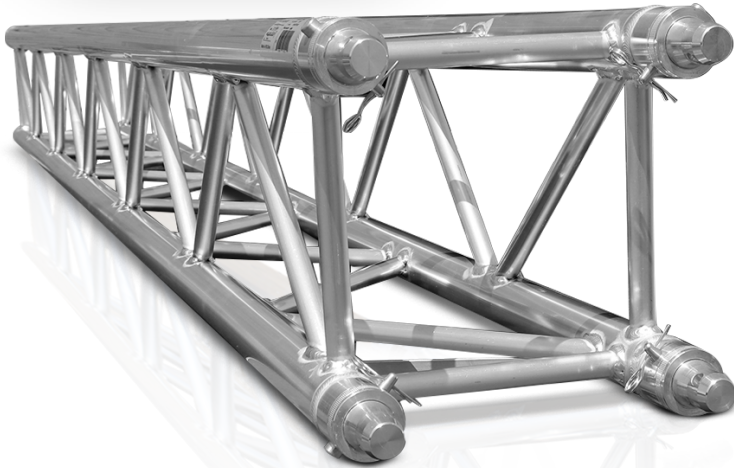

GALAXY STAGE GS34 Series box truss is available in a variety of standard lengths from 0.25 m (0.82 ft) to 3 m (9.84 ft). The GS34 series is made from lightweight 6082-T6 aluminum by TUV certified welders.

GALAXY STAGE truss connects seamlessly with other industry standard brands that use same conical connection system.

- Height: 11.42" (290 mm)
- Width: 11.42" (290 mm)
- 2" (50 mm) outer tube diameter
- 0.75" (20 mm) diagonal bracing
- 0.08" (2mm) wall thickness
- 6082-T6 alloy aluminum
- Manufactured by TUV certified Welders
- Includes coupler, pin and safety clip set for connecting

GS34 LOAD TABLE

TRUSS SPAN		UNIFORMLY DISTRIBUTED LOAD		CENTER POINT LOAD		THIRD POINT LOAD		QUARTER POINT LOAD		FIFTH POINT LOAD	
METERS	FEET	LOAD	DEFLECTION	LOAD	DEFLECTION	LOAD	DEFLECTION	LOAD	DEFLECTION	LOAD	DEFLECTION
2M	6.56ft	649 lbs	0.060 in	4,222 lbs	0.100 in	2,129 lbs	0.090 in	1,419 lbs	0.080 in	1,064 lbs	0.080 in
4M	13.12ft	319 lbs	0.500 in	2,094 lbs	0.400 in	1,570 lbs	0.520 in	1,047 lbs	0.480 in	872 lbs	0.500 in
6M	19.68ft	140 lbs	1.130 in	1,377 lbs	0.910 in	1,033 lbs	1.170 in	688 lbs	1.080 in	574 lbs	1.140 in
8M	26.24ft	77 lbs	2.000 in	1,012 lbs	1.630 in	759 lbs	2.070 in	506 lbs	1.930 in	422 lbs	2.020 in
10M	32.80ft	48 lbs	3.130 in	789 lbs	2.560 in	592 lbs	3.240 in	395 lbs	3.010 in	329 lbs	3.150 in
12M	32.80ft	32 lbs	4.510 in	636 lbs	3.720 in	477 lbs	4.660 in	318 lbs	4.340 in	265 lbs	4.540 in

Information extracted from the structural report by Clark Reder Engineering, Inc.

ITEM NO.	PRODUCT DESCRIPTION	WEIGHT
GS34-025	0.82ft (0.25m) Square Truss Segment	9 lbs
GS34-050	1.64ft (0.5m) Square Truss Segment	13 lbs
GS34-100	3.28ft (1.0m) Square Truss Segment	20 lbs
GS34-150	4.92ft (1.5m) Square Truss Segment	24 lbs
GS34-200	6.56ft (2.0m) Square Truss Segment	29 lbs
GS34-250	8.20ft (2.5m) Square Truss Segment	36 lbs
GS34-300	9.84ft (3.0m) Square Truss Segment	42 lbs

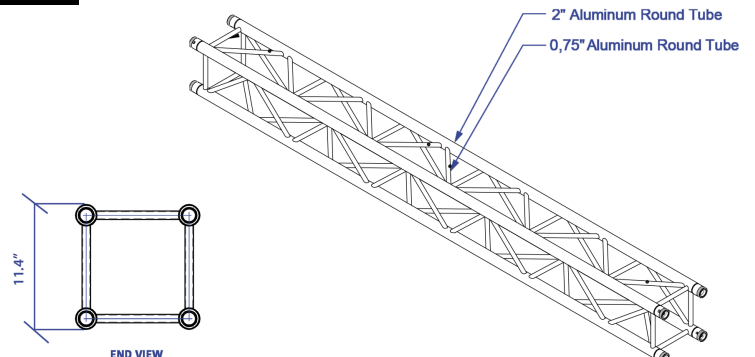

CONTACT



+1 (909) 378-4747



14839 Proctor Ave Suite E
City of Industry, CA 91746



sales@galaxystage.com

DATA SHEET GS12

GALAXY STAGE®

HIGH QUALITY TRUSS, CLAMPS & ACCESSORIES

GS12 12" X 12" ALUMINUM BOX TRUSS

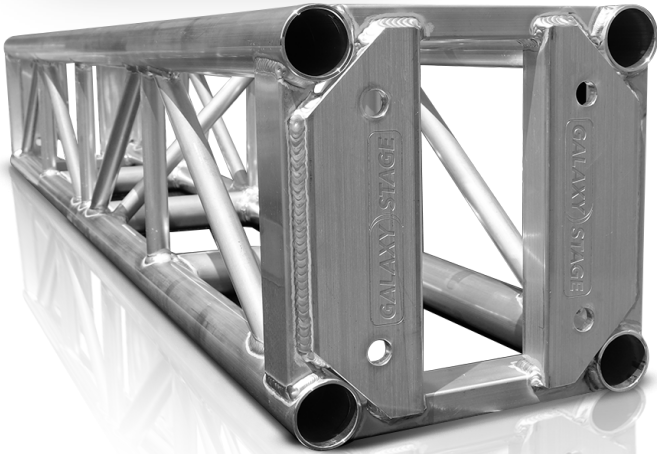





GALAXY STAGE GS12 Series box truss is available in wide variety of standard lengths from 2 ft to 10 ft. The GS12 series is made from 6061 aluminum by certified welders and engineered in the United States.

GALAXY STAGE bolt truss works seamlessly with other industry standard brands that use the same 6.75" bolt pattern joined together with 5/8" grade-8 bolts.

- 2" (50mm) outer tube diameter
- 1" (25 mm) diagonal bracing
- 1/8" (3 mm) wall thickness
- 6061-T6 alloy aluminum
- Manufactured by TUV certified welders
- Includes Grade-8 bolt set

GS12 LOAD TABLE

TRUSS SPAN	UNIFORMLY DISTRIBUTED LOAD		CENTER POINT LOAD		THIRD POINT LOAD		QUARTER POINT LOAD		FIFTH POINT LOAD	
										
FEET	LOAD	DEFLECTION	LOAD	DEFLECTION	LOAD	DEFLECTION	LOAD	DEFLECTION	LOAD	DEFLECTION
10'-0"	442 lbs	0.141 in	3.564 lbs	0.183 in	2.209 lbs	0.194 in	1.473 lbs	0.180 in	1.105 lbs	0.170 in
20'-0"	174 lbs	0.907 in	1.738 lbs	0.738 in	1.303 lbs	0.939 in	869 lbs	0.872 in	724 lbs	0.914 in
30'-0"	72 lbs	2.003 in	1.109 lbs	1.693 in	774 lbs	1.990 in	554 lbs	1.981 in	445 lbs	2.000 in
40'-0"	26 lbs	2.671 in	650 lbs	2.666 in	377 lbs	2.656 in	273 lbs	2.667 in	217 lbs	2.667 in

Information extracted from the structural report by Clark Reder Engineering, Inc.

ITEM NO.	PRODUCT DESCRIPTION	WEIGHT
GS-1202	2' Long, 12" Box Truss with Bolts	21 lbs
GS-1203	3' Long, 12" Box Truss with Bolts	26 lbs
GS-1204	4' Long, 12" Box Truss with Bolts	33 lbs
GS-1205	5' Long, 12" Box Truss with Bolts	35 lbs
GS-1206	6' Long, 12" Box Truss with Bolts	42 lbs
GS-1208	8' Long, 12" Box Truss with Bolts	54 lbs
GS-1210	10' Long, 12" Box Truss with Bolts	62 lbs

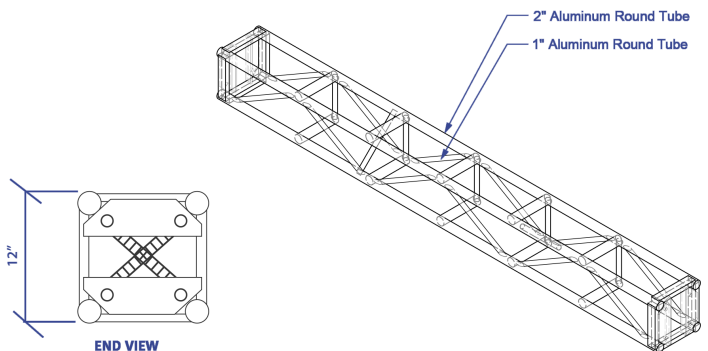

CONTACT

+1 (909) 378-4747

14839 Proctor Ave Suite E
City of Industry, CA 91746

sales@galaxystage.com

DATA SHEET GS20

GALAXY STAGE®

HIGH QUALITY TRUSS, CLAMPS & ACCESSORIES

GS20 20.5" X 20.5" ALUMINUM BOX TRUSS

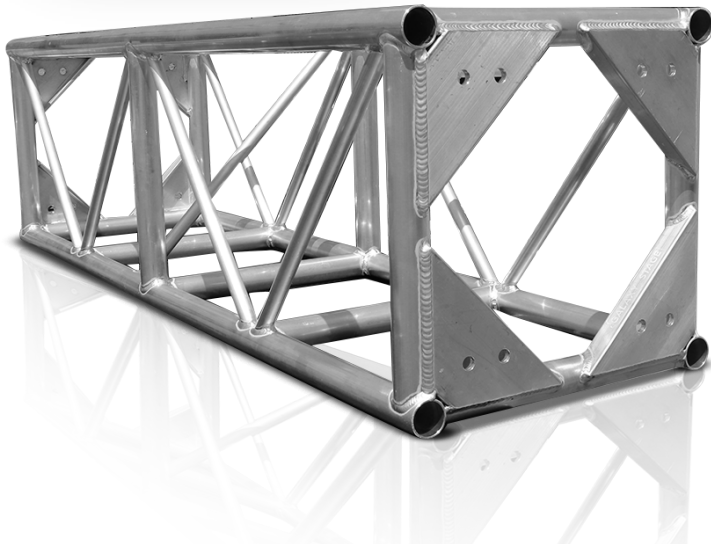





GALAXY STAGE® GS20 series box truss is available in a wide variety of standard lengths from 2 ft to 10 ft. The GS20 series is made from 6061 aluminum by certified welders and engineered in the United States.

GALAXY STAGE® bolt truss works seamlessly with other industry standard brands that use the same bolt pattern joined together with 5/8" Grade-8 steel bolts.

- 2" (50mm) outer tube diameter
- 1" (25 mm) diagonal bracing
- 1/8" (3 mm) wall thickness
- 6061-T6 alloy aluminum
- Manufactured by TUV certified welders
- Includes Grade-8 bolt set

GS20 LOAD TABLE

TRUSS SPAN	UNIFORMLY DISTRIBUTED LOAD		CENTER POINT LOAD		THIRD POINT LOAD		QUARTER POINT LOAD		FIFTH POINT LOAD	
										
FEET	LOAD	DEFLECTION	LOAD	DEFLECTION	LOAD	DEFLECTION	LOAD	DEFLECTION	LOAD	DEFLECTION
10'-0"	517 lb/ft	0.046 in	5,173 lbs	0.074 in	2,587 lbs	0.064 in	1,724 lbs	0.059 in	1,293 lbs	0.056 in
20'-0"	254 lb/ft	0.371 in	2,988 lbs	0.352 in	2,241 lbs	0.449 in	1,494 lbs	0.417 in	1,245 lbs	0.437 in
30'-0"	127 lb/ft	0.976 in	1,912 lbs	0.800 in	1,434 lbs	1.010 in	956 lbs	0.940 in	797 lbs	0.983 in
40'-0"	68 lb/ft	1.735 in	1,351 lbs	1.441 in	1,013 lbs	1.791 in	675 lbs	1.675 in	563 lbs	1.748 in

Information extracted from the structural report by Clark Reder Engineering, Inc.

ITEM NO.	PRODUCT DESCRIPTION	WEIGHT
GS-2002	2' Long, 20.5" Box Truss with Bolts	33 lbs
GS-2003	3' Long, 20.5" Box Truss with Bolts	40lbs
GS-2004	4' Long, 20.5" Box Truss with Bolts	43 lbs
GS-2005	5' Long, 20.5" Box Truss with Bolts	56 lbs
GS-2006	6' Long, 20.5" Box Truss with Bolts	61 lbs
GS-2008	8' Long, 20.5" Box Truss with Bolts	79 lbs
GS-2010	10' Long, 20.5" Box Truss with Bolts	87 lbs

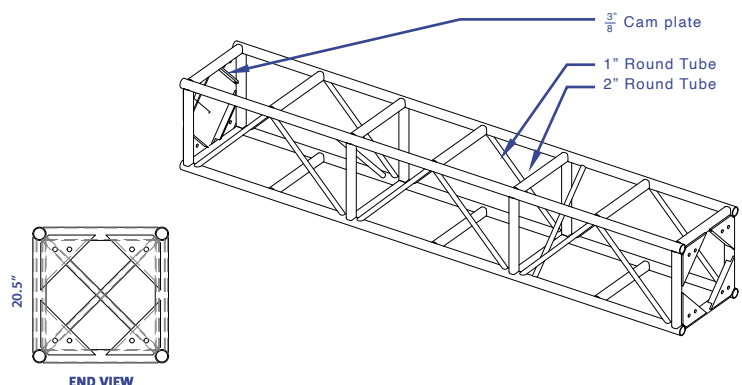

CONTACT

+1 (909) 378-4747

14839 Proctor Ave Suite E
City of Industry, CA 91746

sales@galaxystage.com

DATA SHEET CLAMPS

GALAXY STAGE®

HIGH QUALITY TRUSS, CLAMPS & ACCESSORIES



STANDARD HALF COUPLER

Max. Weight Capacity: 1100 lbs (500 kg)
Minimum Diameter: 1.9" (48 mm)
Maximum Diameter: 2.0" (51 mm)
Bolt size: 3/8" - 16 TPI
Compatible: GS34, GS12 & GS20 Truss
SKU: GS-C102P



SLIM HALF COUPLER

Max. Weight Capacity: 440 lbs (200 kg)
Minimum Diameter: 1.9" (48 mm)
Maximum Diameter: 2.0" (51 mm)
Bolt size: 1/2" - 13 TPI
Compatible: GS34, GS12 & GS20 Truss
SKU: GS-C104P



LEVER TC CLAMP

Max. Weight Capacity: 550 lbs (250 kg)
Minimum Diameter: 1.9" (48 mm)
Maximum Diameter: 2.0" (51 mm)
Bolt size: 1/2" - 13 TPI
Compatible: GS34, GS12 & GS20 Truss
SKU: GS-C106P



QUICK CLAMP

Max. Weight Capacity: 550 lbs (250 kg)
Minimum Diameter: 1.9" (48 mm)
Maximum Diameter: 2.0" (51 mm)
Bolt size: 1/2" - 13 TPI
Compatible: GS34, GS12 & GS20 Truss
SKU: GS-C108



DOUBLE SWIVEL CLAMP

Max. Weight Capacity: 1100 lbs (500 kg)
Minimum Diameter: 1.9" (48 mm)
Maximum Diameter: 2.0" (51 mm)
TUV Approved
Compatible: GS34, GS12 & GS20 Truss
SKU: GS-C110P



SLIM DOUBLE SWIVEL CLAMP

Max. Weight Capacity: 440 lbs (220 kg)
Minimum Diameter: 1.9" (48 mm)
Maximum Diameter: 2.0" (51 mm)
TUV Approved
Compatible: GS34, GS12 & GS20 Truss
SKU: GS-C112P



MINI LIGHT DUTY CLAMP

Max. Weight Capacity: 220 lbs (100 kg)
Minimum Diameter: 1.9" (48 mm)
Maximum Diameter: 2.0" (51 mm)
TUV Approved
Bolt size: M10-1.5
Available in Black
Compatible: GS34, GS12 & GS20 Truss
SKU: GS-C113



HALF CONICAL CLAMP

Max. Weight Capacity: 660 lbs (300 kg)
Minimum Diameter: 1.9" (48 mm)
Maximum Diameter: 2.0" (51 mm)
TUV Approved
Compatible: GS34, GS12 & GS20 Truss
SKU: GS-C114



M10 EYE BOLT

SKU: GS-M10EYE



M12 EYE BOLT

SKU: GS-M12EYE



EYE BOLT ACCESSORY AVAILABLE FOR ALL CLAMP MODELS

CONTACT



+1 (909) 378-4747



14839 Proctor Ave Suite E
City of Industry, CA 91746



sales@galaxystage.com